

MATCHLINE-SEE SHEET C-03.102

**LEGEND**

- EXISTING EDGE OF PAV'T.
- EXISTING CURB & GUTTER
- EXISTING STORM SEWER
- EXISTING WATERLINE
- EXISTING SANITARY SEWER
- EXISTING U/G GAS
- EXISTING FENCE
- EXIST. FIRE HYDRANT
- EXIST. RIP RAP
- EXIST. LIGHT
- EXIST. SIGN
- PROP. CG-6
- PROP. CG-6 TO CG-6R
- PROP. EDGE OF PAVEMENT
- PROP. STORM SEWER
- PROP. NUMBER OF PARKING SPACES
- PROP. RIP RAP
- PROP. INDEX CONTOUR
- PROP. INTERMEDIATE CONTOUR
- PROP. SPOT ELEVATION

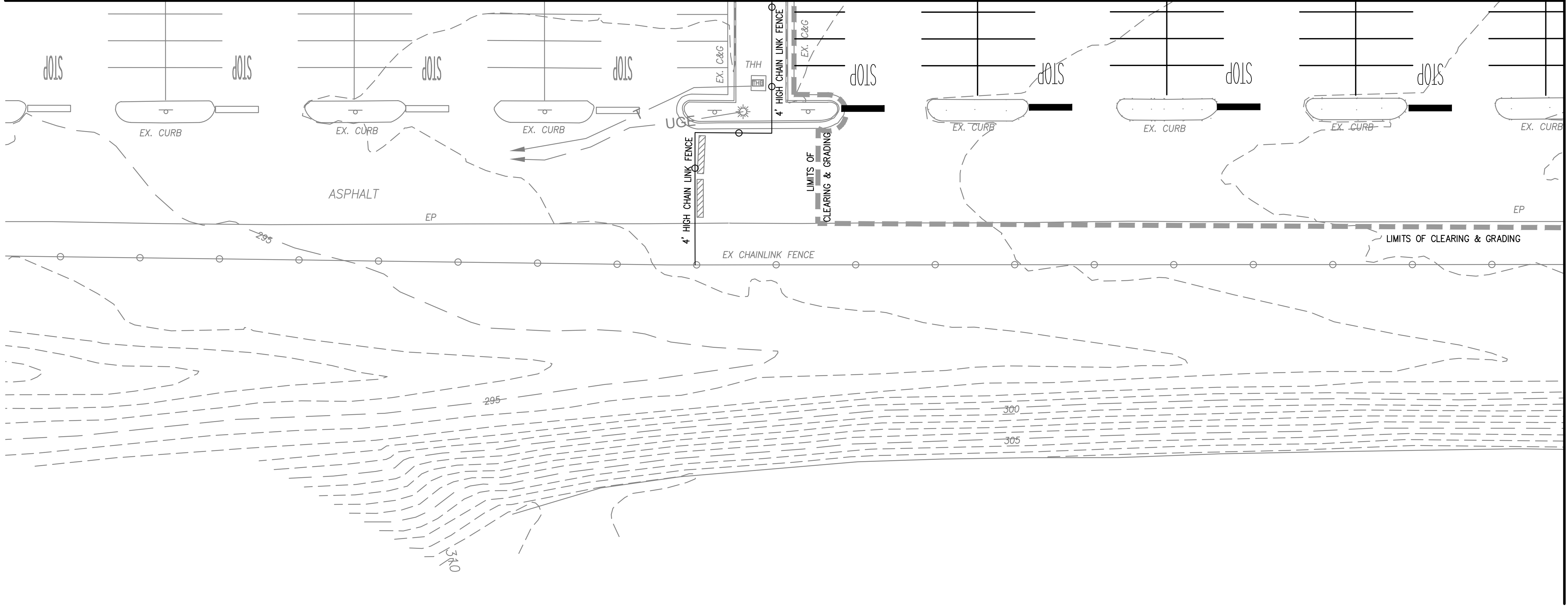

- NOTES:**
1. WHERE NEW PAVEMENT IS CALLED FOR, CONTRACTOR SHALL SAWCUT ALL JOINTS AND REPLACE WITH ASPHALT SECTION AS SHOWN ON C-02.200.
  2. BACKFILL BEHIND CURB WITH APPROVED MATERIAL. SEED, MULCH, AND WATER TO ESTABLISH A 6" STAND OF GRASS.
  3. SEE SHEET C-05.100 FOR UTILITY PROFILES.

MATCHLINE-SEE SHEET C-03.103

MATCHLINE-SEE SHEET TOP RIGHT

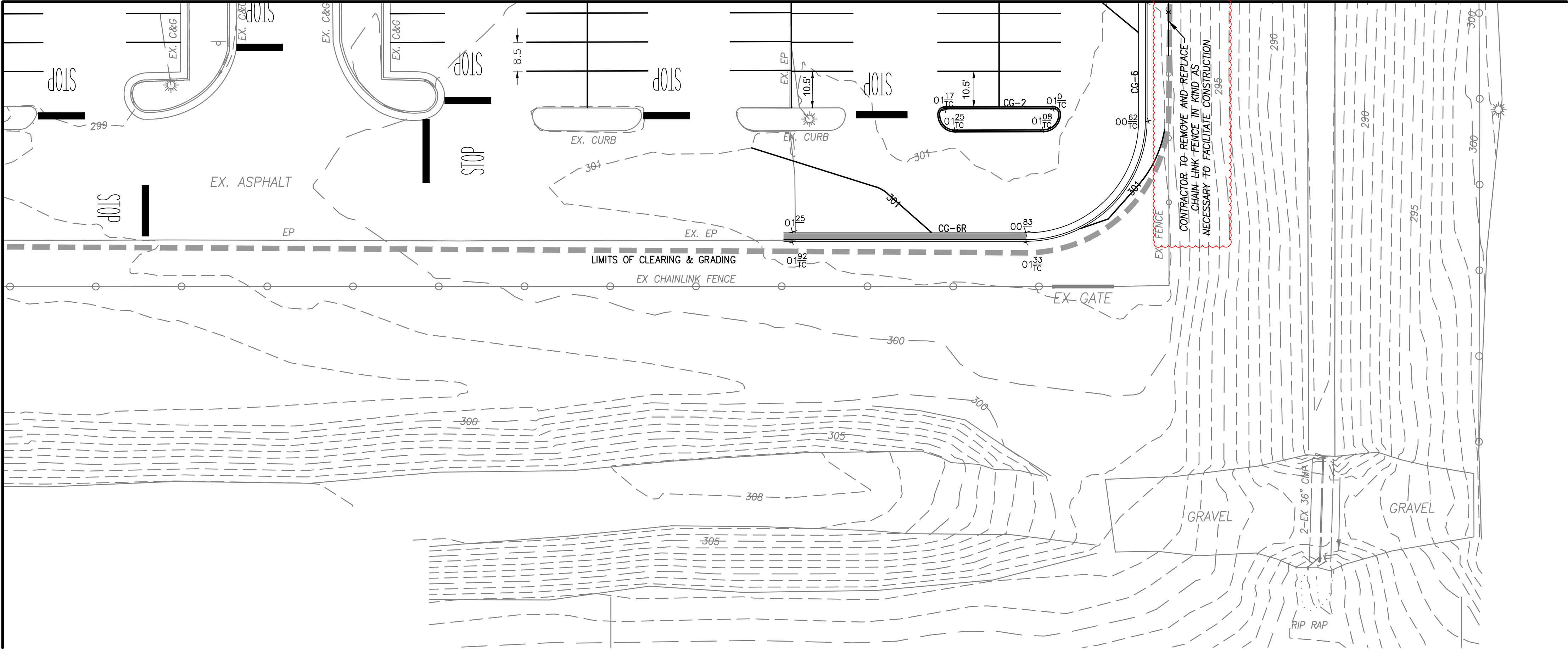

MATCHLINE-SEE SHEET BOTTOM LEFT



Dewberry Engineers, Inc  
1503 Edwards Ferry Road  
Suite 200  
Leesburg, VA 20176-6680  
703.771.9504

Ehler Bryan  
8609 Westwood Center Drive  
Suite 800  
Tysons, VA 22182  
703.827.9552

Mueller Associates, Inc.  
1306 Concourse Dr  
Suite 100  
Linthicum, Maryland 21090  
410.646.4500

**DULLES NORTH  
TRANSIT CENTER  
RELOCATION  
SITE PLAN**  
DULLES ELECTION DISTRICT  
LOUDOUN COUNTY, VIRGINIA

SEAL

**KEY PLAN**

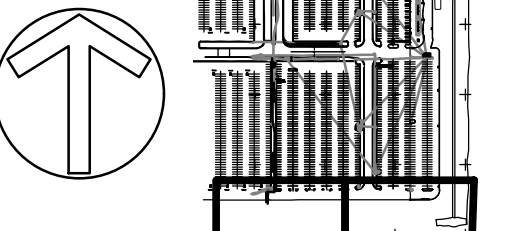

**SCALE**



**REVISIONS**

NO.	DESCRIPTION	DATE
1	ADDENDUM 1	11/4/23
0	PERMIT SET	9/21/23

DRAWN BY EL, JS  
APPROVED BY DT  
CHECKED BY LR  
DATE SEPTEMBER, 2020

**TITLE**

**SITE PLAN**

PROJECT NO. \_\_\_\_\_

**C-03.104**

SHEET NO. \_\_\_\_\_ OF 57